



BOERPLAY

Multi Swing Anti-wrap



BBPE038.8K

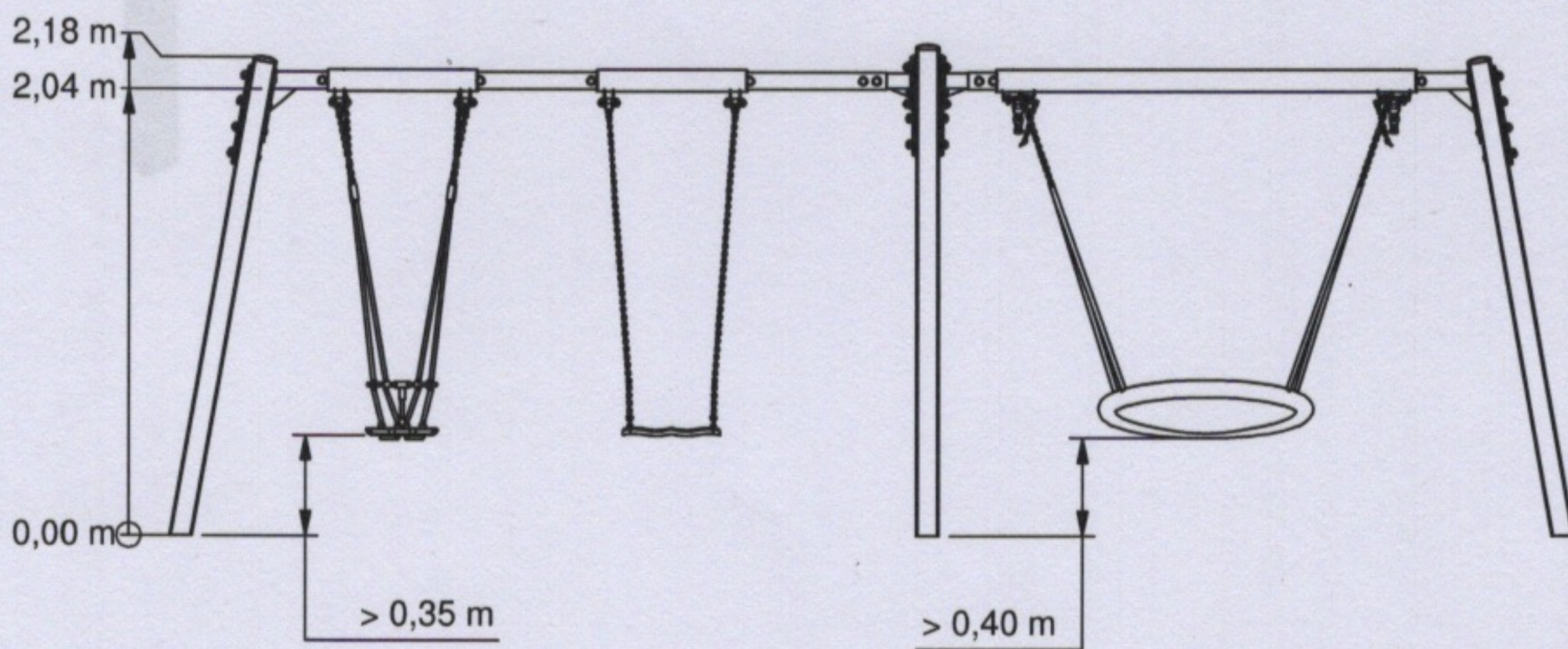
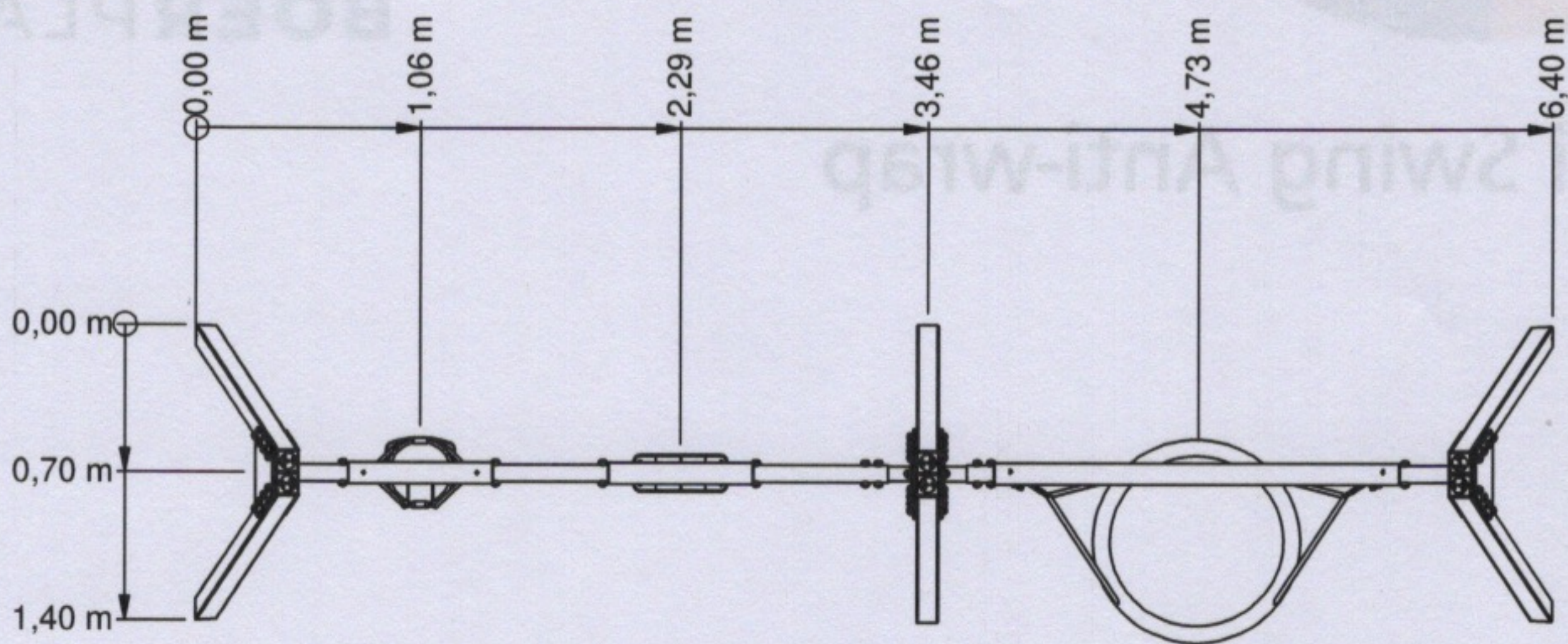

Benaming
Title Tweekbeuksschommel

Opmerking
Comment Boer Basic Play

Datum
Date 30-11-2023

Tekening
Drawing

TOE BBP 038 8K

Hoofdafmetingen Main dimensions

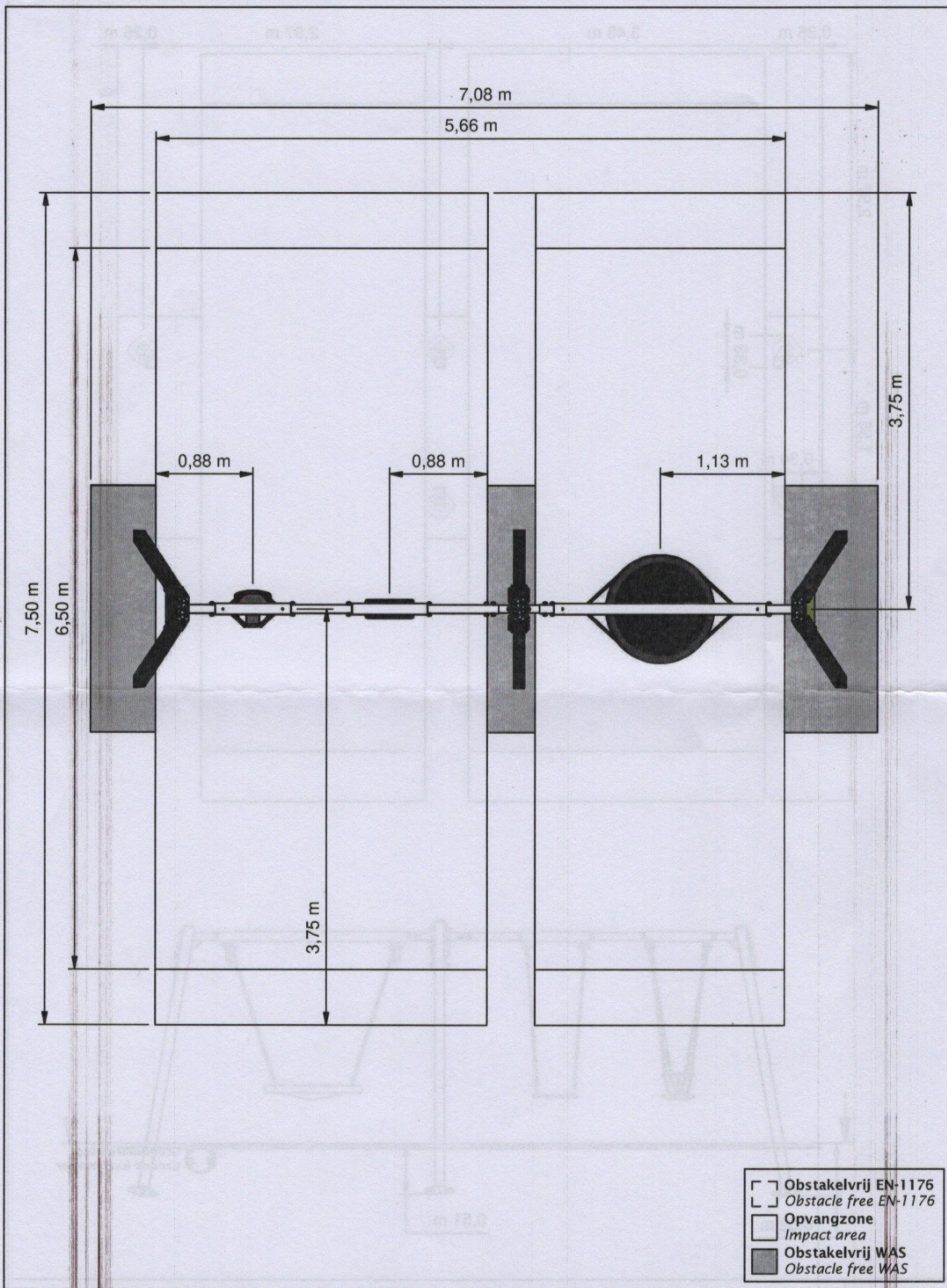

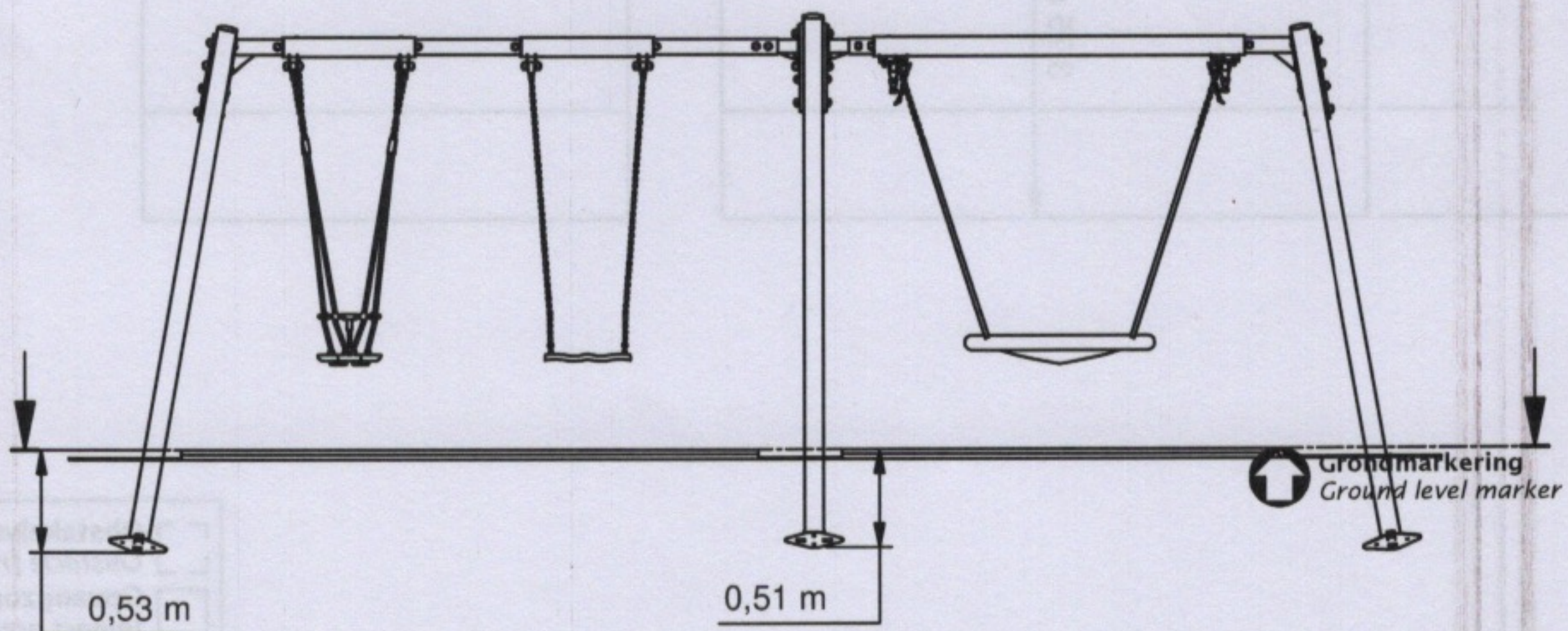
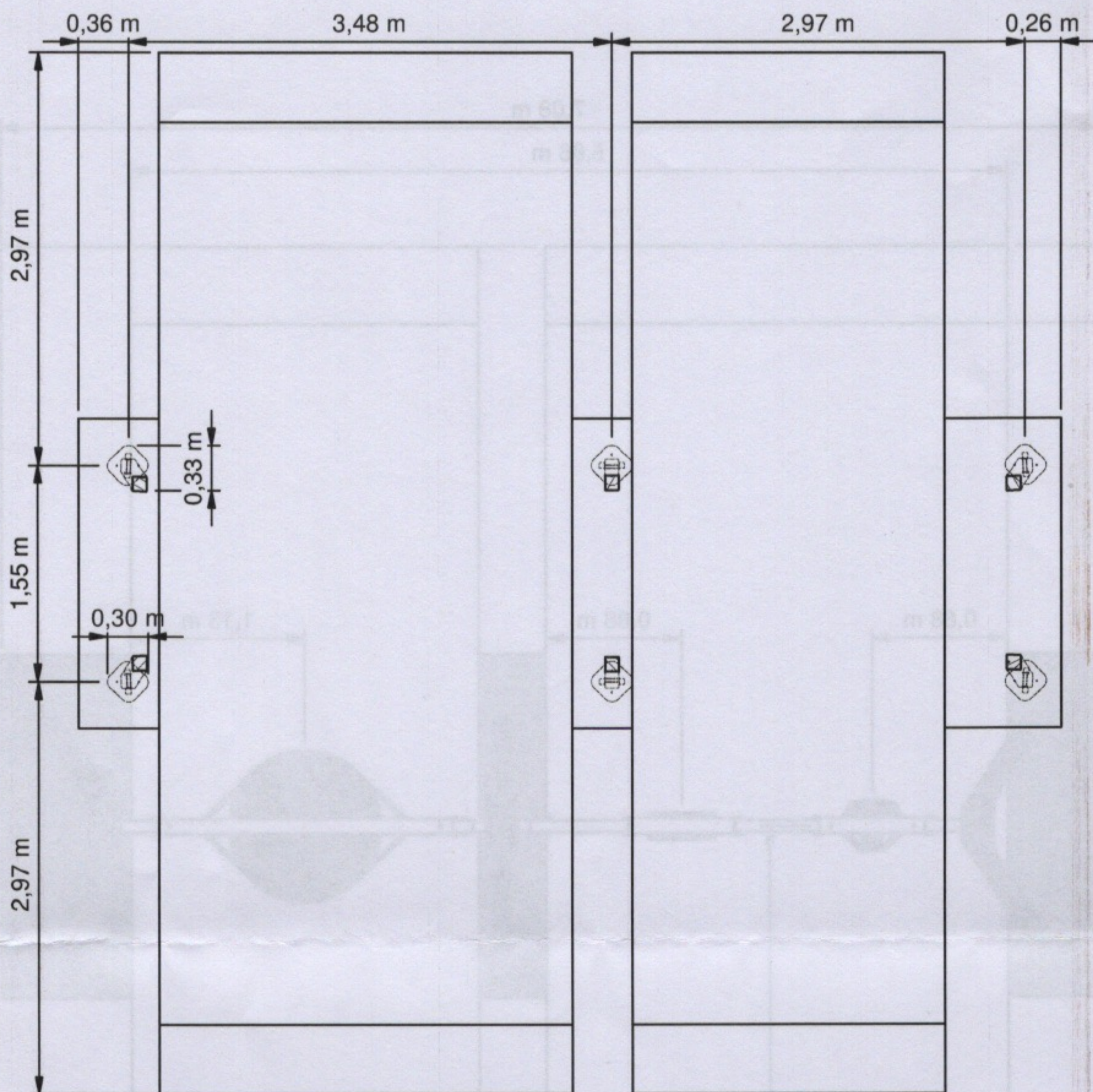

BOER

Benaming
Title Tweebeuksschommel

Opmerking
Comment Boer Basic Play

Datum
Date 30-11-2023

Tekening
Drawing

TOE BBP 038 8K

Bodemplan Groundplan

Geleverde modules:

Zie tabel

Montageinstructie:

- De hoofdmaten geven de maten van de staanders en vloeren aan
- De detailtekeningen geven specifiek de maten van de verbindingen aan
- De modules met buizen zijn op de tekeningen bemaat op bovenkant kopplaat
- Overige modules zijn bemaat op de bovenkant (klimwanden, paalkappen, etc.)

Montagevolgorde:

- 1 - Graaf de gaten volgens het bodemplan
- 2 - Plaats 3
- 3 - Plaats 4 en 5, verbind deze aan 3
- 4 - Plaats twee keer 1, verbind deze aan 4
- 5 - Plaats 2, verbind deze aan 5
- 6 - Controleer of het toestel voldoet aan de afmetingen zoals op blad 'afmetingen'
- 7 - Dicht de gaten en verdicht het zand

Controles:

- 1 - Correcte opbouw en alle bevestigingsmiddelen
- 2 - Controleer de afmetingen van de valbodem t.o.v. het toestel

Supplied modules:

See table

Assembly instruction:

- The main dimensions indicate the dimensions of the posts and floors
- The detailed dimensions show the specific dimensions of the connections
- The modules which contain tubes are dimensioned at the top of the flanges
- Other modules are dimensioned at the top (climbing walls, caps for the posts, etc.)

Assembly sequence:

- 1 - Dig the holes according to the ground plan
- 2 - Place 3
- 3 - Place 4 and 5, attach it to 3
- 4 - Place two times 1, attach it to 4
- 5 - Place two times 2, attach it to 5
- 6 - Check that the equipment conforms to the dimensions shown on sheet 'dimensions'
- 7 - Close the holes and compact the sand

Checks:

- 1 - Correct assembly and all the fasteners
- 2 - Check the dimensions of the safety area with regard to the play equipment

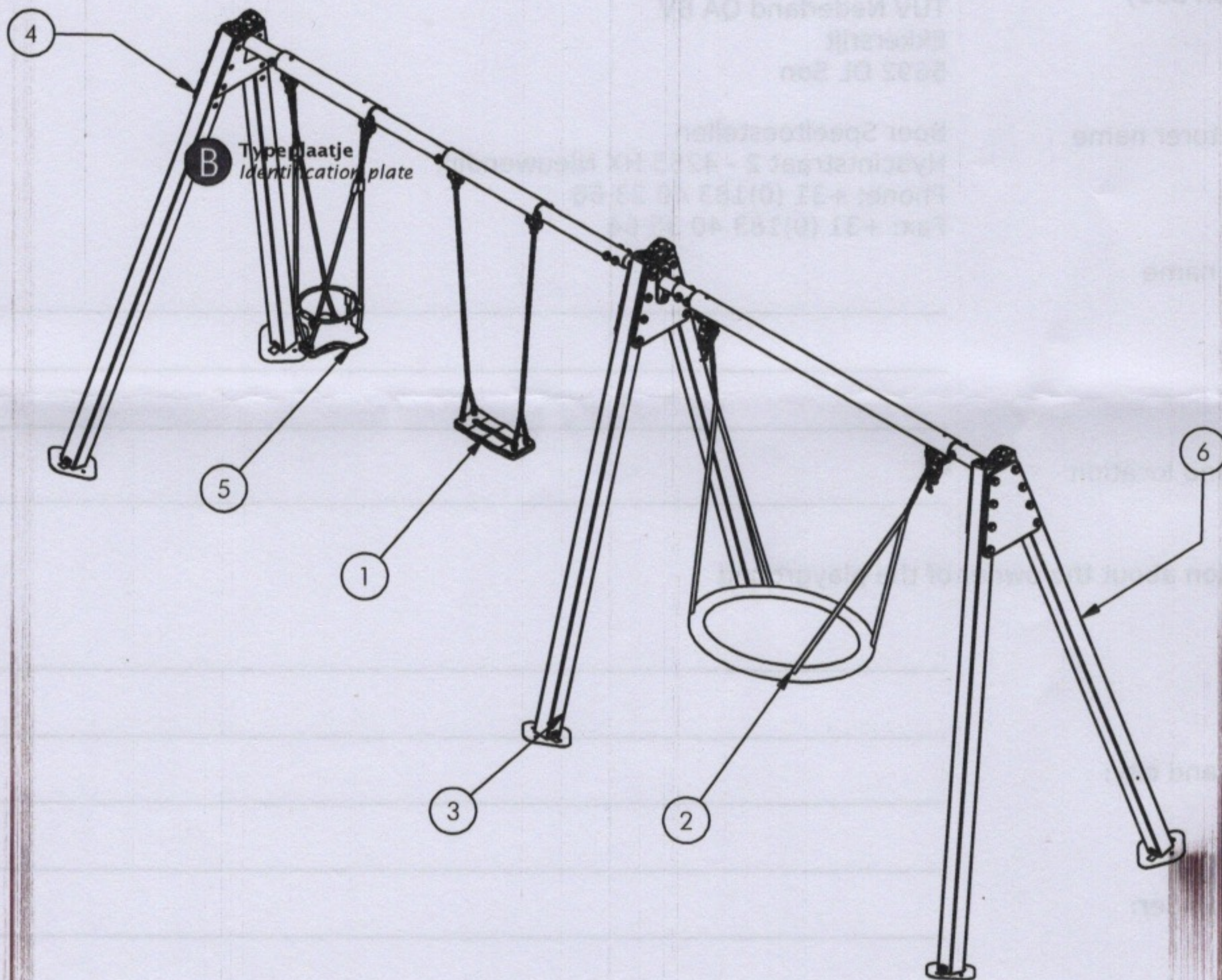

Nr.	#	Type	Progr.	Volgnr.	Bew.	Rev.	Benaming	Opmerking
1	1	MOD	BBP	538	G		Basic Play	Overgooi Zitje 1,5 m
2	1	MOD	BBP	540	G	B	Overgooi Vogelnest	Basic Play
3	1	MOD	BBP	552	K	C	Tussenmodule schommel	Boer Basic play
4	1	MOD	BBP	585	K		Aanbouwschommel AW	Boer Basic play
5	1	MOD	BBP	680	G		Multi Swing	Peuterzitje lengte 1.5 m
6	1	MOD	BBP	682	K		Eindmodule schommel	Boer Basic Play

Benaming
Title TweebeuksschommelOpmerking
Comment Boer Basic PlayDatum
Date 30-11-2023Tekening
Drawing

TOE BBP 038 8K

Modules Modules

BBPE038.8K

Multi Swing Anti-wrap

LOGBOOK

Type indication Basic Play
Article number BBPE038.8K
Product Name Multi Swing Anti-wrap
Construction year 2024
Certificate 066453
Inspection body TUV Nederland QA BV
Ekkersrijt
5692 DL Son

Manufacturer name Boer Speeltoestellen
Hyacintstraat 2 - 4255 HX Nieuwendijk
Phone: +31 (0)183 40 23 66
Fax: +31 (0)183 40 35 64

Installer name

Playground location

Information about the owner of the playground

Name:

Address:

Zipcode and city:

Contact:

Phone number:

Information about the manager of the playground

Name:

Address:

Zipcode and city:

Contact:

Phone number:



Inspection and maintenance

Accidents

Date accident	Age of victim	Probable cause of injury	Occurred injury	Measures taken after accident

Inspection and maintenance intervals

Nr.	Inspection	Maintenance	months between inspections
1	Verify equipment's stability, junctions and missing parts. Inspect bolts, screws and nuts for absence, jams, corrosion and wear.	Add missing parts, secure joints, apply missing fixing agent and replace corroded parts.	1
2	Check suspension for wear.	Replace worn parts and/or remove non-functioning parts.	1
3	Inspect rotating parts such as hinges, rolling-element bearings, etc. for wear and acceptability.	Replace worn parts and/or remove non-functioning parts.	1
4	Check wood for splinters, unacceptable damage and signs of rot, especially at ground level.	Repair damage. Replace affected wood. Smoothen splintered wood and sharp edges.	1
5	Inspect foundation for stability, tearing and coverage.	Restore foundation and covering material.	3
6	Examine rubber and synthetic parts for wear, damage and breakage.	Replace for OEM original parts.	3
7	Examine fibre reinforced plastic parts, especially slides, for wear.	Replace for OEM parts if the fibres are visible.	6
8	Inspect metal for corrosion and damage in the coating.	Restore any damaged coating (after removing rust and applying primer).	6
9	Check ropes, cables, chains and nets for wear and damage. Steel cables and nets which are tensioned must be checked for tension.	Replace parts where necessary. Steel cables and nets must be tensioned.	3
10	Inspect equipment for unsafe changes and additions.	Remove unsafe additions and correct unsafe changes.	1
11	Inspect safety surfaces.	Restore and repair where necessary.	1

Remarks

1. If used intensively, all points require extra attention.
2. Extreme weather conditions and locations may require a higher inspection frequency. Discuss this with the supplier.
3. Vandalism-sensitive locations require stricter inspections, possibly daily.
4. Re-tighten all connections in Robinia equipment two months after first use.
5. Re-span spatial networks two months after first use.
6. Check the terrain regularly for items that do not belong there, are unsafe or may be used wrongly. Examples are poisonous plants, glass shards, etc. Frequency depends on strain.

7. Remember that bad maintenance leads to unsafe conditions and notably faster impoverishment of the playground area.
8. Replacement parts can be ordered at the manufacturer with the OEM part numbers on the module drawing. Drawings can be found in the user guide.
9. The impact area shall be provided with impact attenuating surface according to the specified falling height.
 - Up to 0,6m height of fall: no requirements regarding impact attenuation.
 - Turf, topsoil: suitable up to 1000mm height of fall.
 - Loose fill (sand, gravel, bark, woodchips): up to 3000mm height of fall. Layer thickness is height of fall / 10 + 100mm, with a minimum of 300mm.
 - Synthetic surfaces (Rubber tiles, artificial turf, wetpour, tigermulch etc.): height of fall and layer thickness according to the information of the supplier.
10. This list is conform the CEN-standard "playground equipment and surfacing NEN-EN 1176-7".

Improving the foundations

(for equipment without concrete in the standard foundation)

If the impact area is loose fill (sand, gravel, bark, woodchip, etc.), or if the soil itself does not add to stability of the equipment (i.e. sand, pumice, peat soil) pour 50l of concrete per post.

For instance:

Square: 0,6 x 0,6 x 0,16m

Round: $\varnothing 0,35 \times 0,5\text{m}$

Round: $\varnothing 0,50 \times 0,2\text{m}$

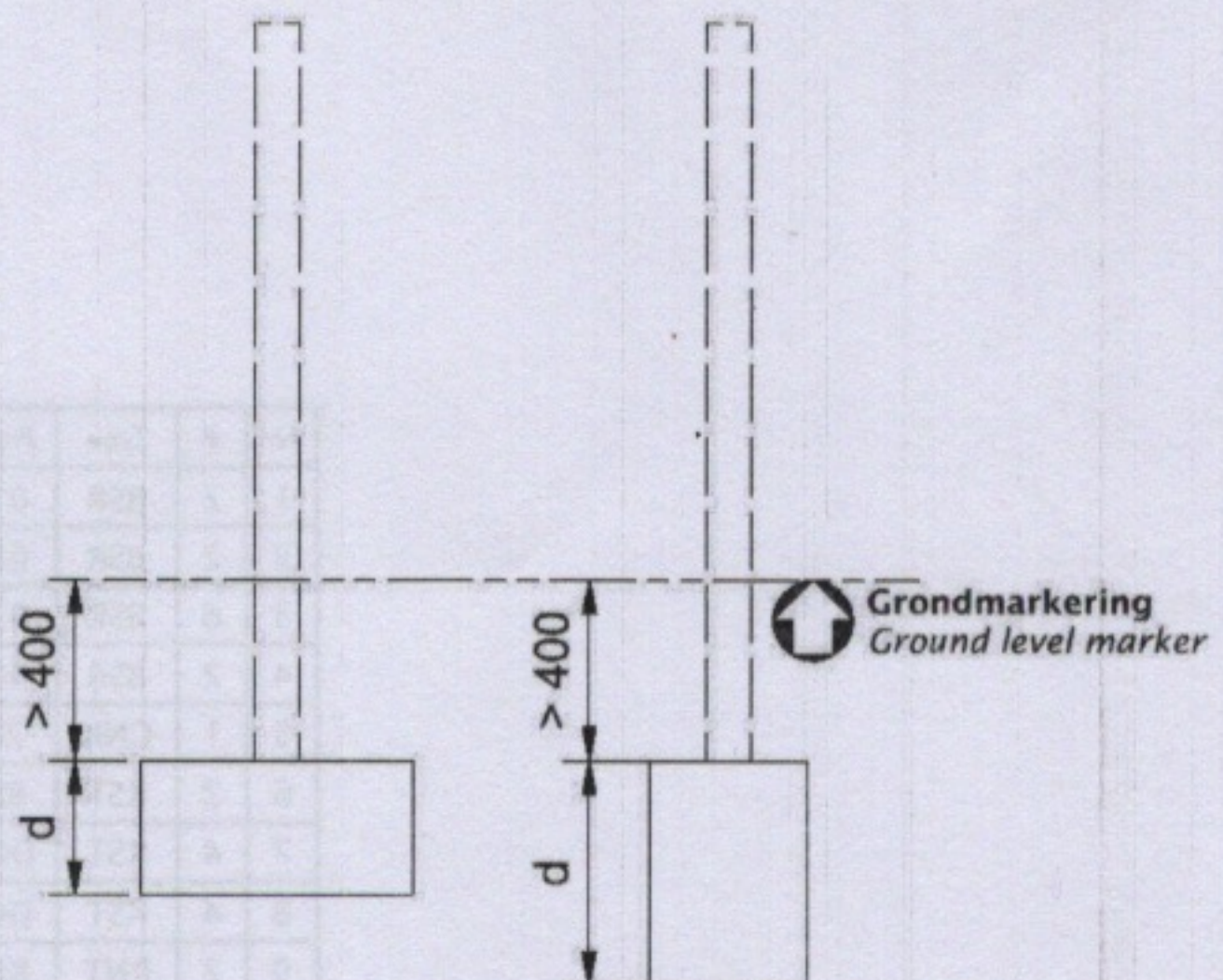
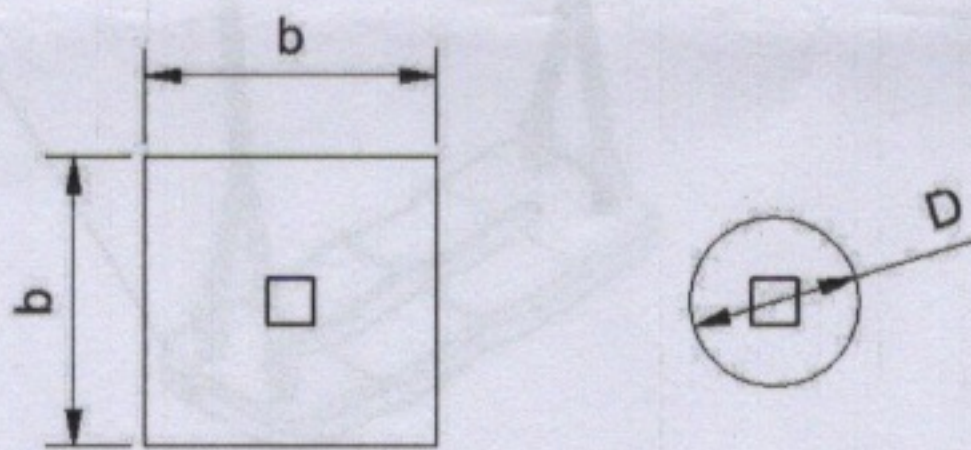

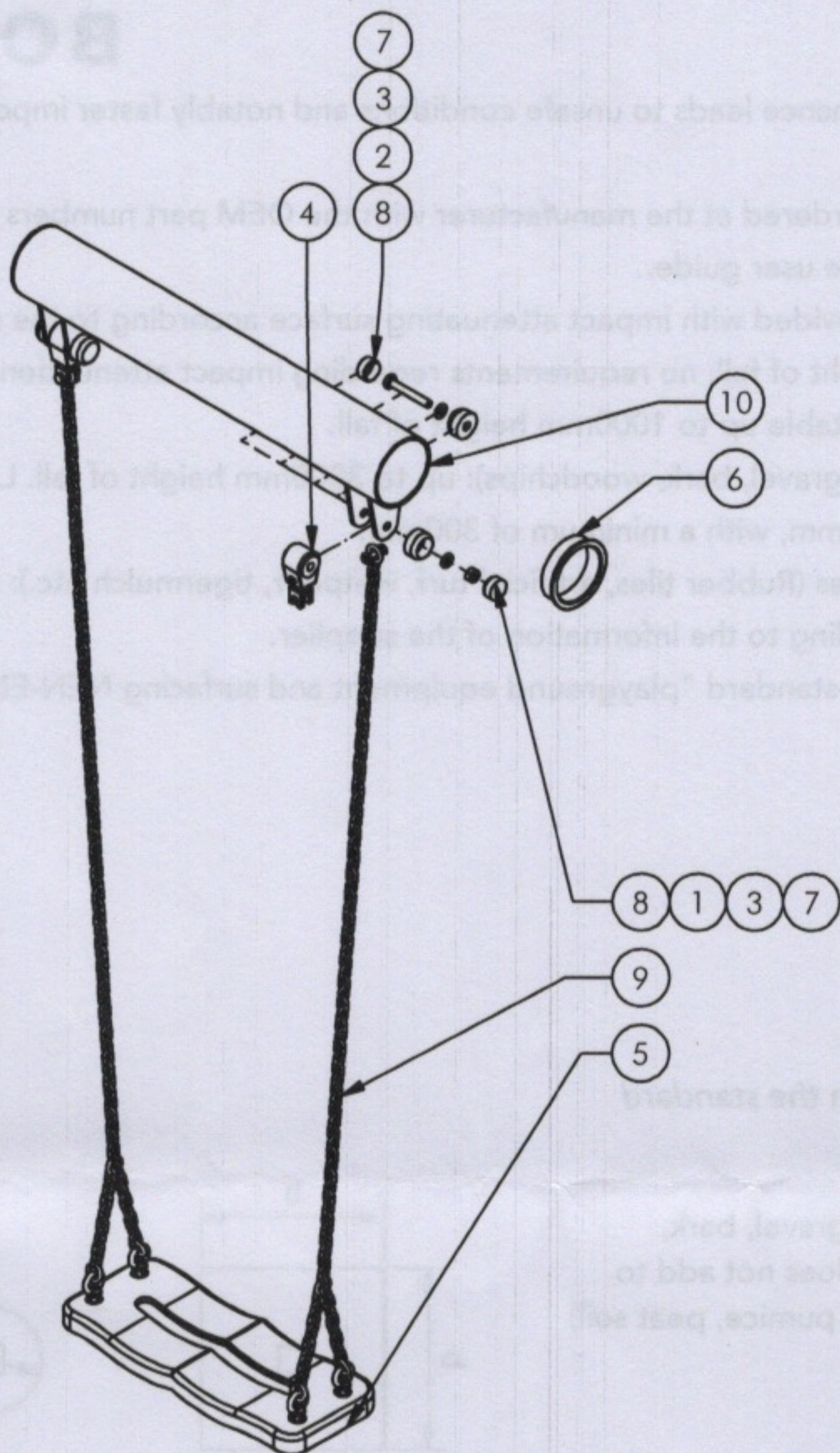

Nr	#	Type	Progr.	Volgnr	Bew.	Rev.	Benaming	Opmerking
1	2	BSR	010	010	010		Borgmoer	M10 - RVS A2-70
2	2	BSR	021	010	070		Zeskantbout	M10 x 70 - RVS A2-70
3	6	BSR	030	010	002		SLUITRING	M10
4	2	BSR	081	012	090		Schommelscharnier	RVS A2-70
5	1	CNK	ZIT	101	ZWT		Zitje CNK + bevm	Zwart
6	2	KST	BBP	026			Lagerring	BBP Schommel
7	4	KST	DON	010	060		Bescherm dop M10-M12	Donut zwart
8	4	KST	DOP	010	060		Bescherm dop M10-M12	Dop zwart
9	2	RNT	KET	005	145		Schommelketting 5mm	Met vork 1,45 m
10	1	SME	UBP	200	916	D	UBP Schommelbuis	Schommel dubbel

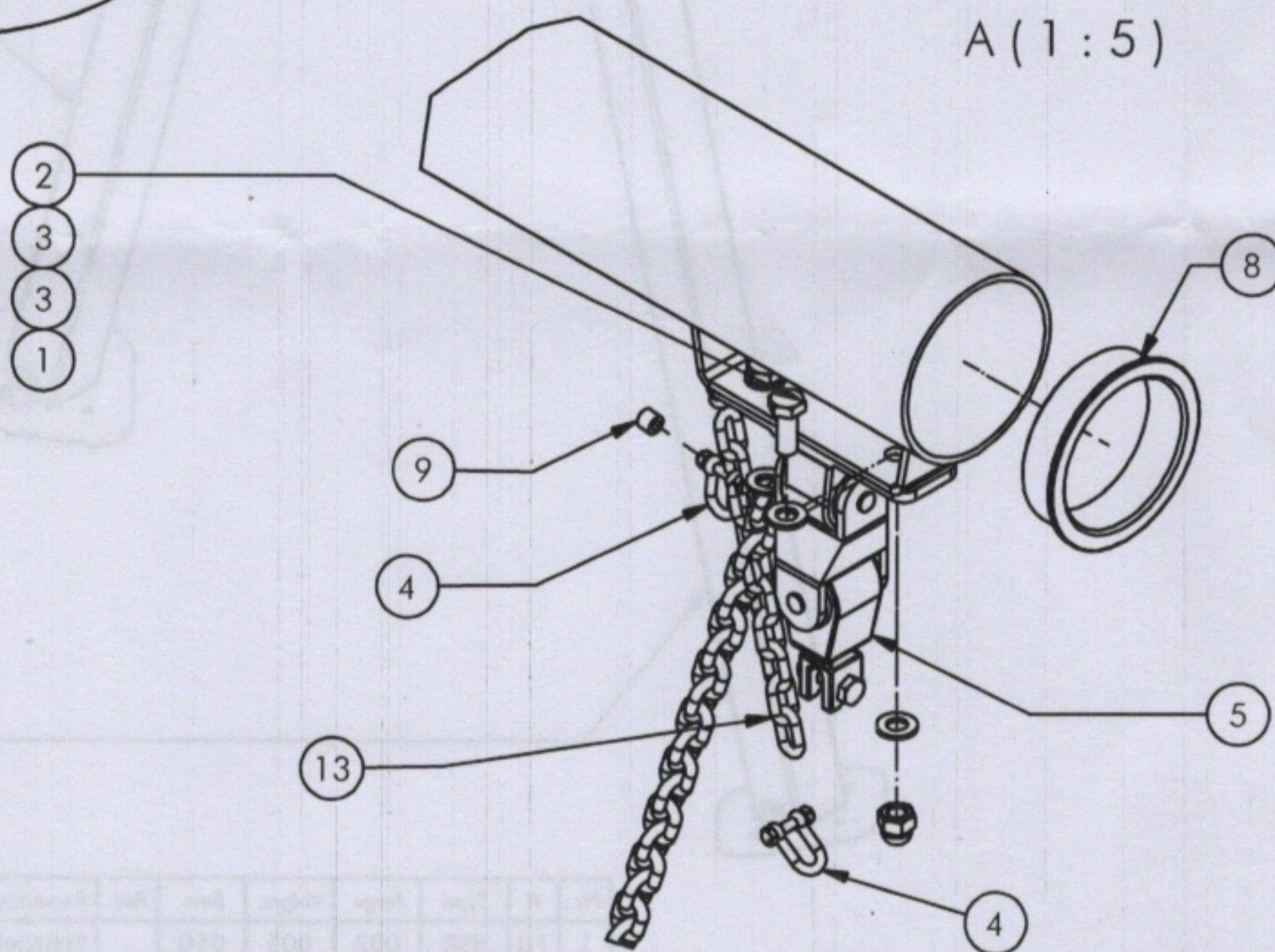
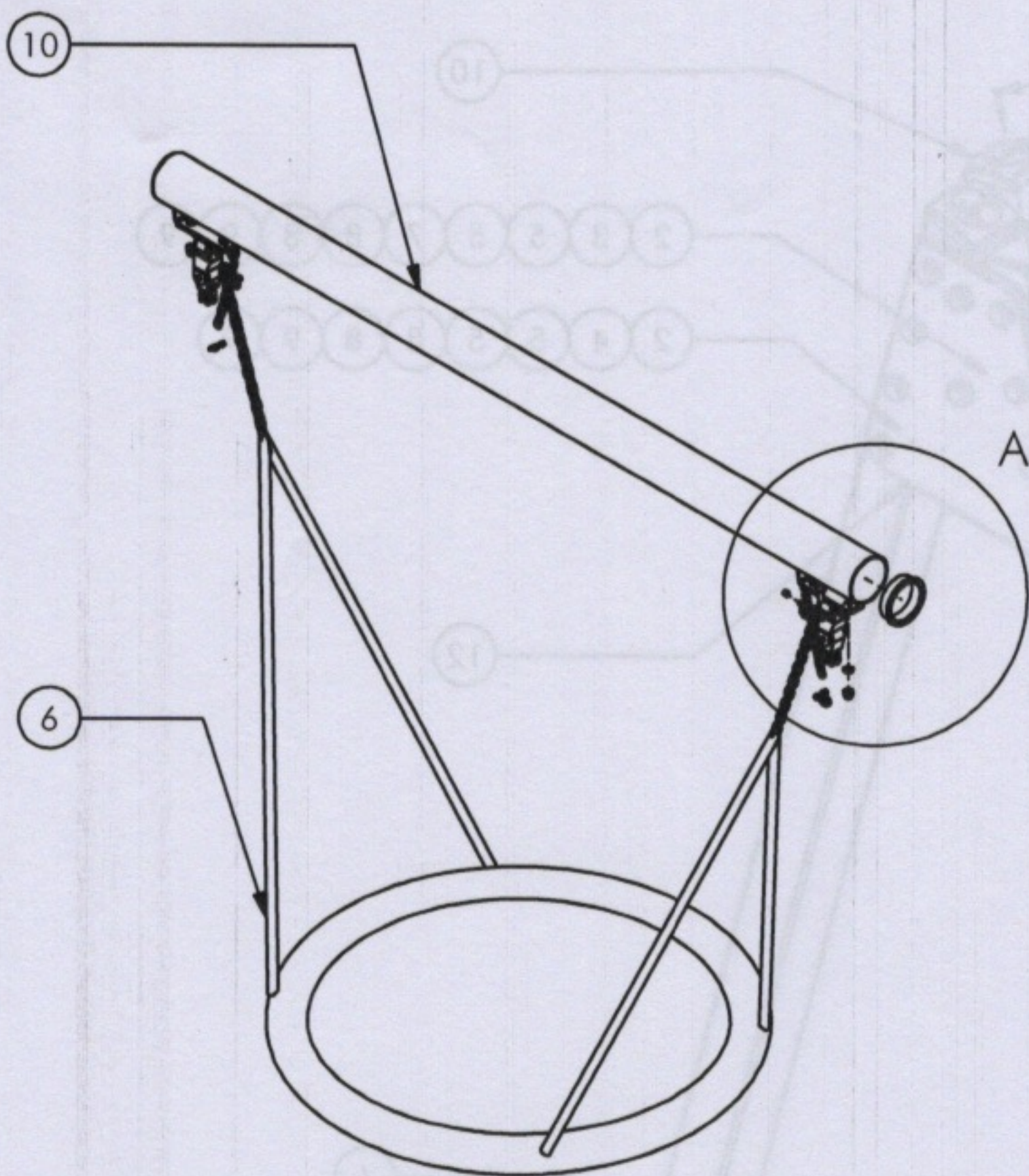

Nr.	#	Type	Progr.	Volgnr.	Bew.	Rev.	Benaming	Opmerking
1	4	BSR	011	010	020		DOPMOER	BORG RVS M10
2	4	BSR	021	010	025		Zeskantbout	M10 x 25 - RVS A2-70
3	8	BSR	030	010	002		SLUITRING	M10
4	4	BSR	031	005	000		D-sluiting	5 MM RVS
5	2	BSR	081	012	092		Scharnier dubbel NORMAAL	RVS A2-70
6	1	DRD	NST	001	100		Vogelnest Ø1,0 m	balk 2,5 m
8	2	KST	BBP	026			Lagerring	BBP Schommel
9	2	KST	RNG	005	008		RING	KUNSTSTOF
10	1	SME	SOL	228	502	A	Overgooi Buis	TBV Vogelnest
13	2	KET	005	002	018		RVS ketting 5mm	0,18 m lang



BOEP

Benaming
Title Overgooi Vogelnest

Opmerking
Comment Basic Play

Datum
Date 16-3-2020

Tekening
Drawing

MOD BBP 540 G B

Samenstelling module Assembly module

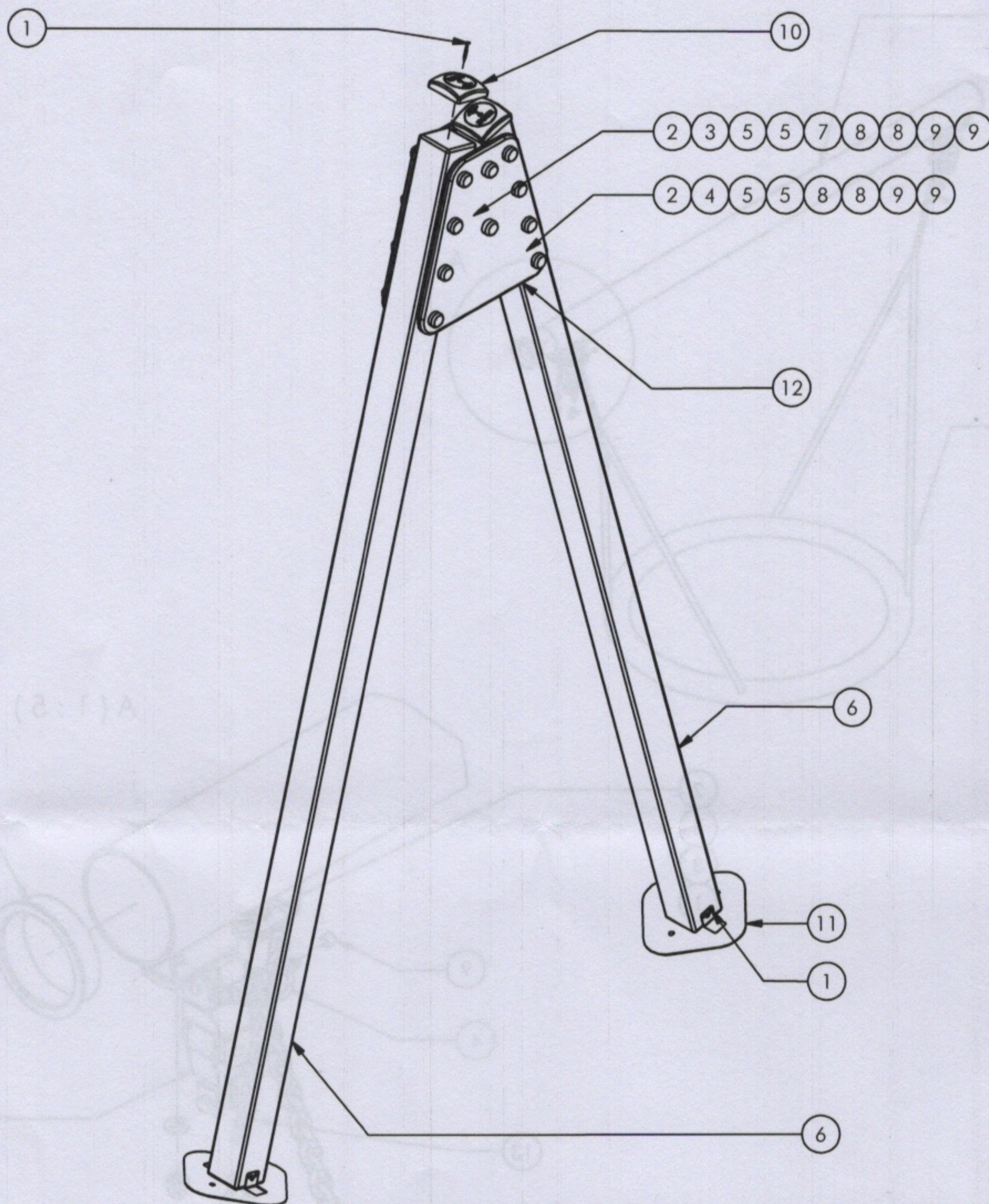

Nr.	#	Type	Progr.	Volgnr.	Bew.	Rev.	Benaming	Opmerking
1	10	BSR	002	005	050		Schroef Assy	5 x 50 - RVS A2-70
2	10	BSV	010	010	010		Borgmoer	M10 - VZ 8.8
3	2	BSV	021	010	180		Zeskantbout ISO 4014	M10 x 180 - VZ 8.8
4	8	BSV	021	010	160		Zeskantbout ISO 4014	M10 x 160 - VZ 8.8
5	20	BSV	030	010	002		SLUITRING	M10 VZ
6	2	KST	BBP	027			Staander schommel	Basic Play
7	2	KST	BBP	050	001		Afstandsbus	100x30x14
8	20	KST	DON	010	020		Beschermcap M10-M12	Donut wit
9	20	KST	DOP	010	020		Beschermcap M10-M12	Dop wit
10	2	OME	KAP	100	524	C	Paalkap 100x100	
11	2	OME	VRB	903	VZP	C	Voetplaat	100 x 100
12	2	OPE	BBP	081	061	A	Paneel midden	Basic Play

Nr.	#	Type	Progr.	Volgnr.	Bew.	Rev.	Benaming	Opmerking
1	10	BSR	002	005	050		Schroef Assy	5 x 50 - RVS A2-70
2	6	BSV	010	010	010		Borgmoer	M10 - VZ 8.8
3	8	BSV	017	010	008		ZESKANT MOER	M10
4	6	BSV	021	010	100		Zeskantbout ISO 4014	M10 x 100 - VZ 8.8
5	6	BSV	026	010	145		Slotbout	M10 x 145 - VZ 8.8
6	2	BSV	026	010	135		Slotbout	M10 x 135 - VZ 8.8
7	20	BSV	030	010	002		SLUITRING	M10 VZ
8	8	BSV	034	010	002		Veerring	M10 - VZ 8.8
9	2	KST	BBP	027			Staander schommel	Basic Play
10	8	KST	DON	010	020		Beschermddop M10-M12	Donut wit
11	12	KST	DON	110	060		Beschermddop M10-M12	Donut zwart ronding 100
12	8	KST	DOP	010	020		Beschermddop M10-M12	Dop wit
13	12	KST	DOP	010	060		Beschermddop M10-M12	Dop zwart
14	2	OME	KAP	100	524	C	Paalkap 100x100	
15	2	OME	VRB	903	VZP	C	Voetplaat	100 x 100
16	1	OPE	BBP	007	061	A	Schommelpaneel	Basic Play
17	1	SME	BBP	062	916	A	Eindstuk bovenbalk	Anti-overgooischommel
18	1	SME	BBP	063		C	Bovenbalk	Anti-overgooischommel



assembly manual - module

NL Montagehandleiding - module
DE Montageanleitung - Modul
ES Manual de ensablado - módulo
FR Manuel de montage - module

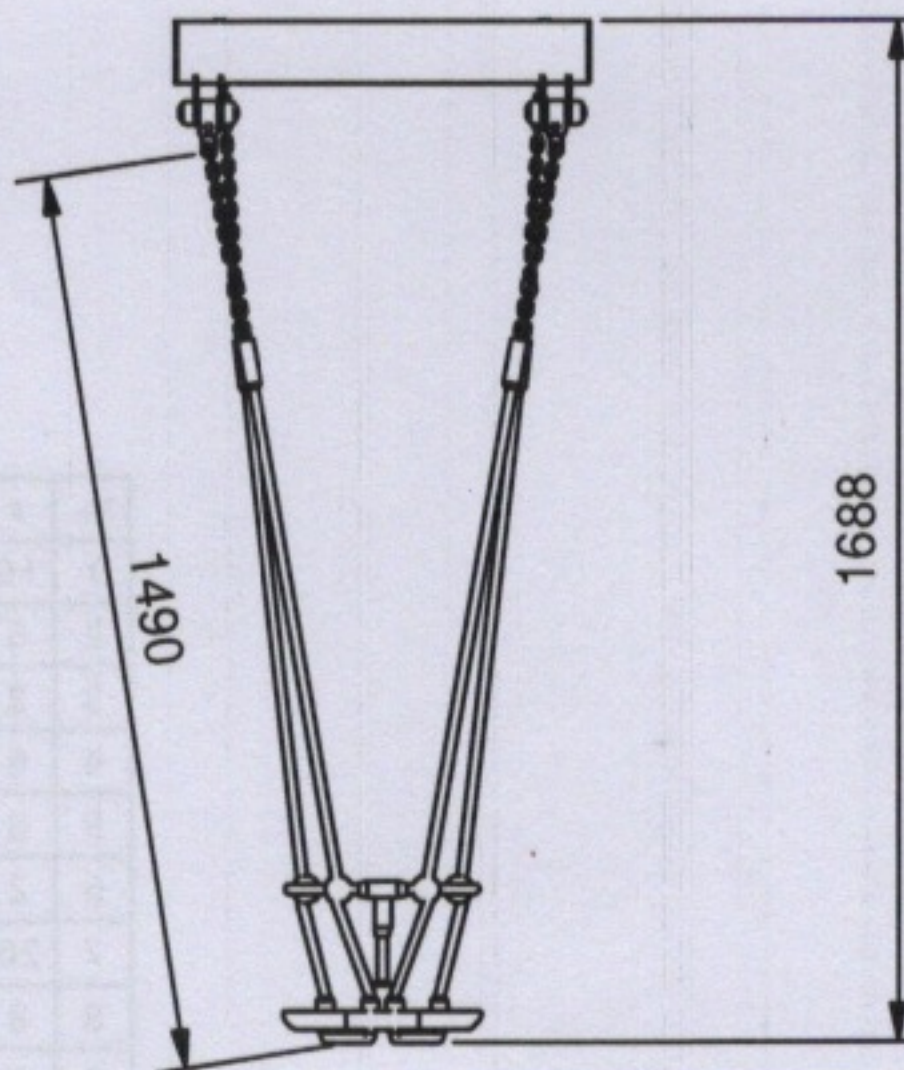
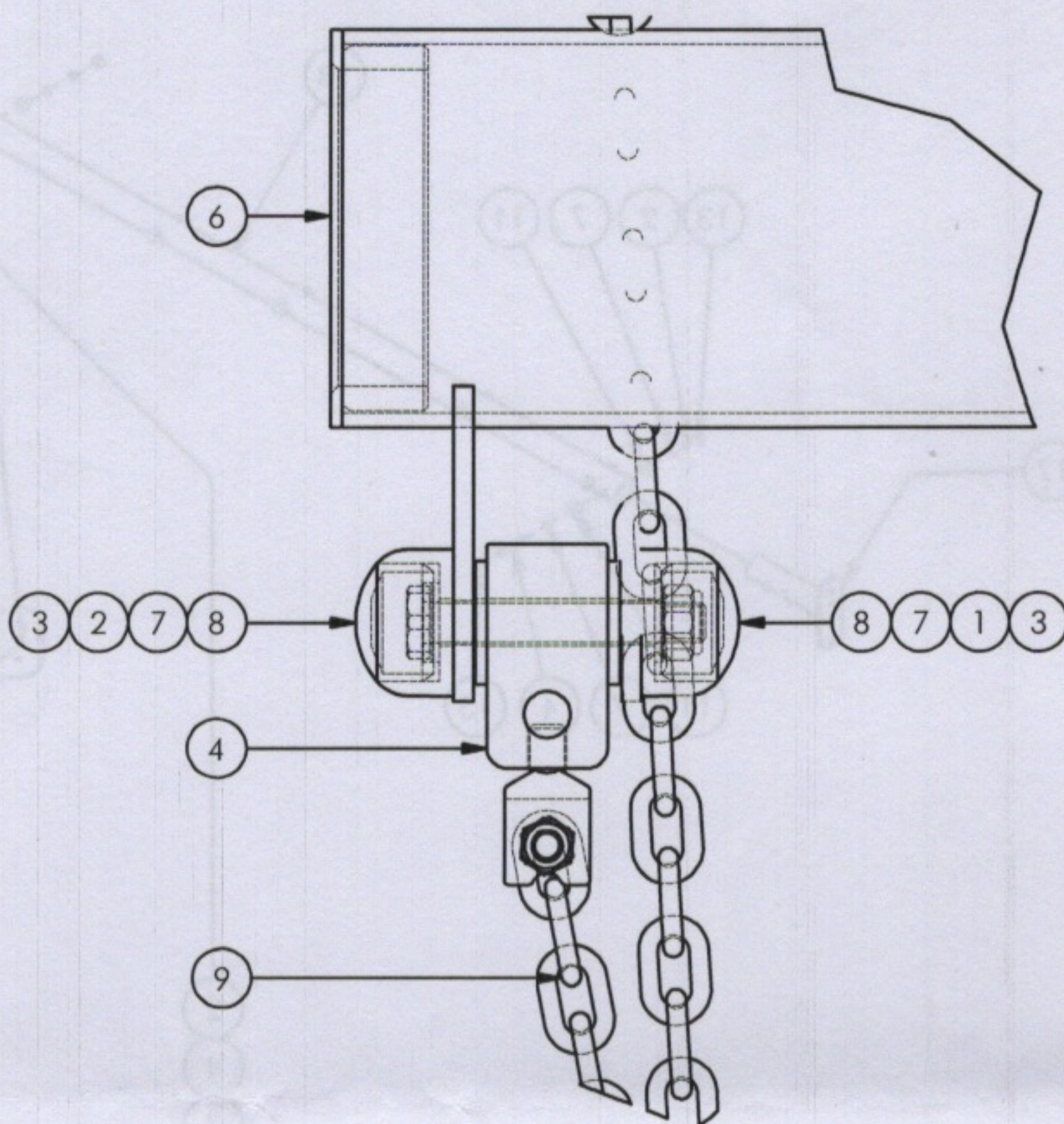
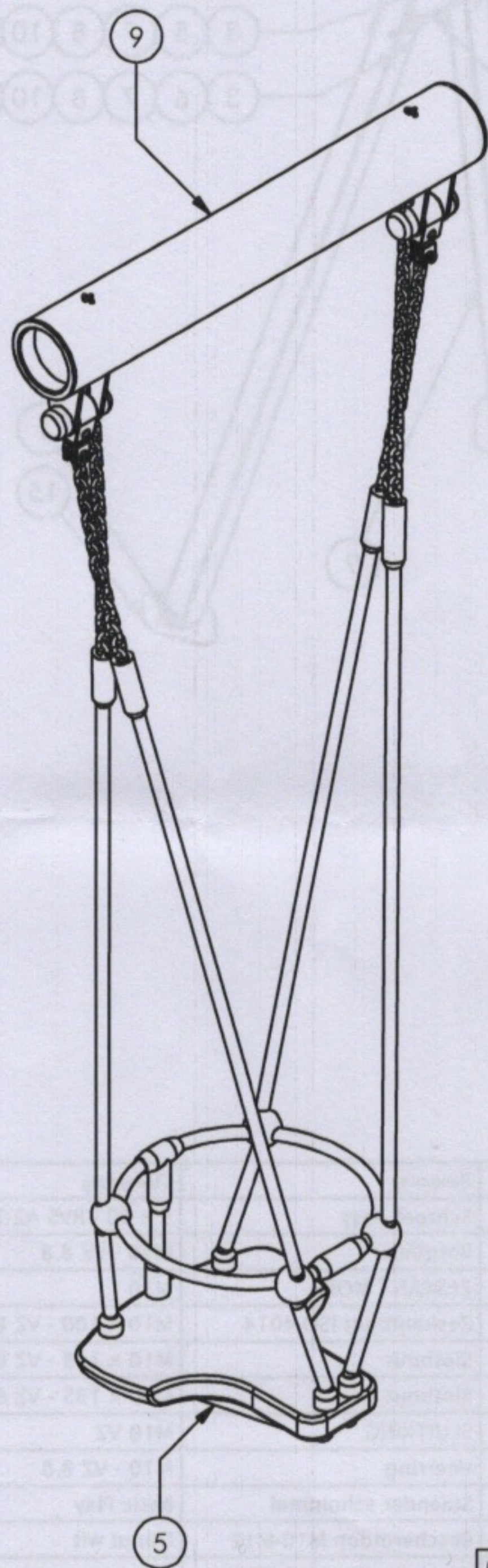

Nr.	#	Type	Progr.	Volgnr.	Bew.	Rev.	Benaming	Opmerking
1	2	BSR	010	010	010		Borgmoer	M10 - RVS A2-70
2	2	BSR	021	010	070		Zeskantbout	M10 x 70 - RVS A2-70
3	6	BSR	030	010	002		SLUITRING	M10
4	2	BSR	081	012	090		Schommelscharnier	RVS A2-70
5	1	DRD	HUC	001		B	Peuterschommel	Peuterzitje
6	2	KST	BBP	026			Lagerring	BBP Schommel
7	4	KST	DON	010	060		Bescherm dop M10-M12	Donut zwart
8	4	KST	DOP	010	060		Bescherm dop M10-M12	Dop zwart
9	1	SME	UBP	200	916	D	UBP Schommelbuis	Schommel dubbel

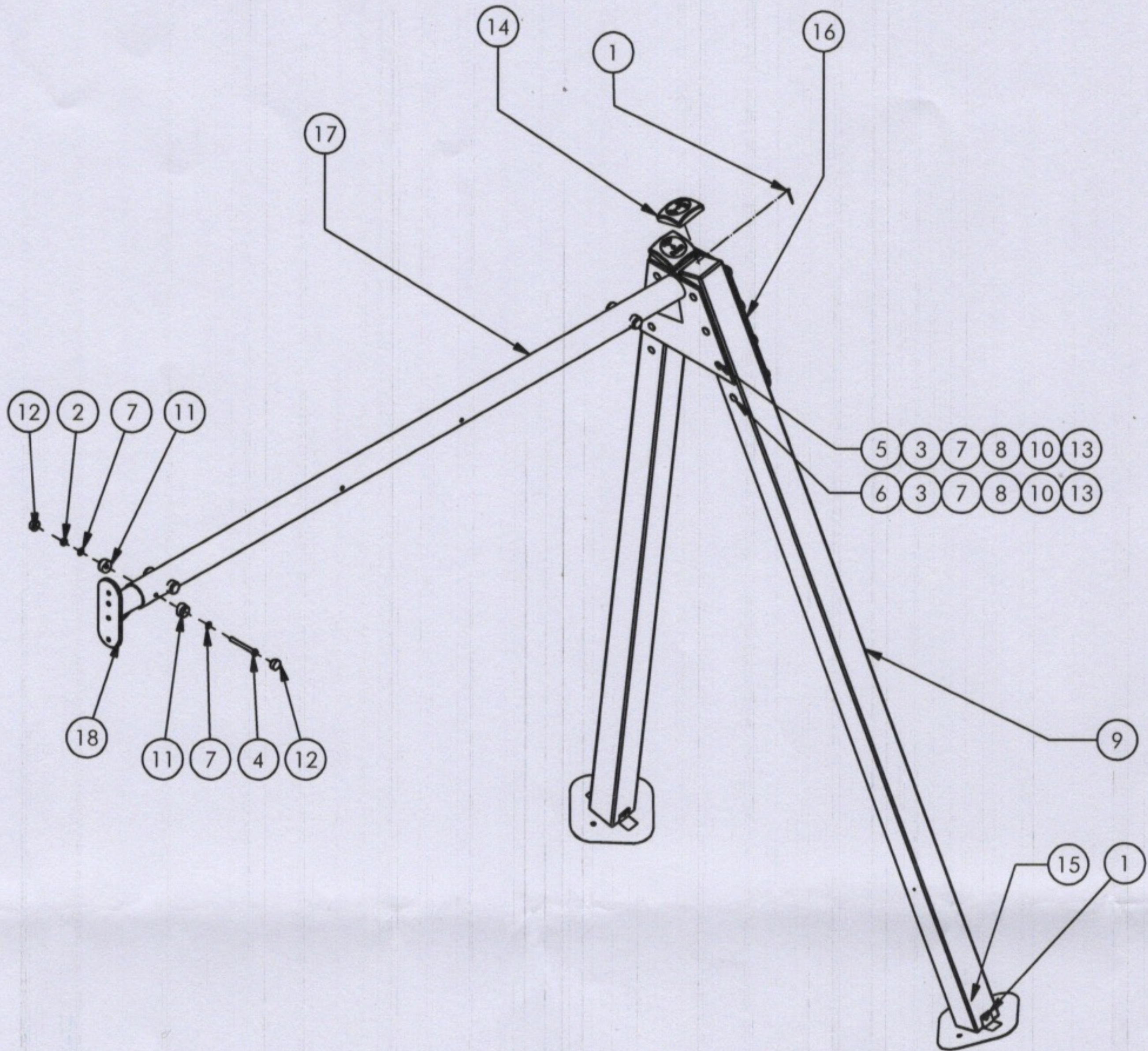

Nr.	#	Type	Progr.	Volgnr.	Bew.	Rev.	Benaming	Opmerking
1	10	BSR	002	005	050		Schroef Assy	5 x 50 - RVS A2-70
2	3	BSV	010	010	010		Borgmoer	M10 - VZ 8.8
3	8	BSV	017	010	008		ZESKANT MOER	M10
4	3	BSV	021	010	100		Zeskantbout ISO 4014	M10 x 100 - VZ 8.8
5	6	BSV	026	010	145		Slotbout	M10 x 145 - VZ 8.8
6	2	BSV	026	010	135		Slotbout	M10 x 135 - VZ 8.8
7	14	BSV	030	010	002		SLUITRING	M10 VZ
8	8	BSV	034	010	002		Veerring	M10 - VZ 8.8
9	2	KST	BBP	027			Staander schommel	Basic Play
10	8	KST	DON	010	020		Bescherm dop M10-M12	Donut wit
11	6	KST	DON	110	060		Bescherm dop M10-M12	Donut zwart ronding 100
12	6	KST	DOP	010	060		Bescherm dop M10-M12	Dop zwart
13	8	KST	DOP	010	020		Bescherm dop M10-M12	Dop wit
14	2	OME	KAP	100	524	C	Paalkap 100x100	
15	2	OME	VRB	903	VZP	C	Voetplaat	100 x 100
16	1	OPE	BBP	007	061	A	Schommelpaneel	Basic Play
17	1	SME	BBP	038	916	B	Bovenbalk	Anti-overgooischommel
18	1	SME	BBP	062	916	A	Eindstuk bovenbalk	Anti-overgooischommel



BOEP

Benaming
Title Eindmodule schommel

Opmerking
Comment Boer Basic Play

Datum
Date 23-11-2023

Tekening
Drawing

MOD BBP 682 K

Samenstelling module Assembly module

General Inspection Regime for Recycled Plastic Play Items and Components

Operators responsibilities

The Health & Safety at Work Act 1974, along with The Management of Health & Safety at Work Regulations 1992 and the Occupiers Liability Act 1957 & 1984 provide a framework to which all owners and operators of play areas should work. Under these Statute Laws there is a legal responsibility placed upon the playground operator to ensure the health and safety of all visitors to the playground.

Playground Managers have a legal responsibility of care to children using the area and at the same time need to meet the expectations of the courts. In our experience, meeting or resisting injury claims has very often turned on the quality of the inspections, subsequent maintenance and the quality of the retained documentation.

BS EN 1176 recommends a three-tier inspection regime following the guidelines set out below:

Routine Visual Inspection

Looking at the equipment's basic condition, especially faults due to recent vandalism, breakages and also cleanliness of the playground. These inspections can be carried out by the manager or staff and should be recorded on a simple sheet or book. These inspections should be carried out daily or weekly dependent on the age of the equipment, usage and levels of vandalism experienced.

Operational Inspection

Looking in more detail at the condition of the equipment, providing a quality control check on the more regular inspections and identifying wear and tear on the equipment. Such inspections should be carried out by an appropriately trained member of staff, or alternatively by a suitably qualified specialist and should be recorded. These inspections should be carried out at least on a quarterly basis.

Annual inspection

To be carried out by a specialist not connected with the playground operator or manager. Essentially looking at vandalism, wear and tear, long-term structural problems, Standards compliance and design, along with risk assessment etc. This report essentially covers the overall safety of the playground.

	Inspection Process/Care	Maintenance or Remedial action
General cleanliness	Inspect for signs of fungal growth	Use domestic cleaning products, or in severe cases specialised, fungus applications to remove
	Inspect for graffiti	Use domestic cleaning fluids and/or specialised graffiti remover to remove
Broken or missing parts	Inspect for any broken, missing or damaged parts, special attention should be given to areas or parts of the equipment that users can access them.	Where possible remove any rough or sharp edges to leave a smooth finish; if the component has suffered severe damage through vandalism it may need to be completely replaced.
Loose or missing fixings	Inspect the equipment for loose or missing fixings	Replace and/or secure all loose or missing fixings
General wear & tear	Our equipment is designed to be robust and has very few areas that will be impacted by wear.	Check that any moving parts are operating correctly.
Stainless steel components & fixings	Stainless steel may have some small impurities that will discolour and leave small rust spots.	Remove by wiping down with a lightly oiled cloth or a domestic type abrasive soap pad.
Aluminium posts	Aluminium used in our products has a powder coated finish and will only require the general cleaning routines to be applied.	Use domestic cleaning products, or in severe cases specialised, fungus applications to remove.
	Inspect for damage to the paintwork.	Treat any rusting areas and repaint.
Rungs, Handrails & Musical Instruments	Anodised components used in our products and will only require the general cleaning routines to be applied.	Use domestic cleaning products, or in severe cases specialised, fungus applications to remove.
Moulded rubber components	Inspect for any damage or deterioration of the component.	Use domestic cleaning products to remove any marks.
Steel core cable	Inspect for any damage to outer covering and check for any broken inner strands.	If any inner strands are broken the component must be replaced.
Polycarbonate components	Inspect for damage to components.	Remove any rough or sharp projections or if damage is severe, replace completely.
	Inspect for signs of fungal growth.	Use domestic cleaning products, or in severe cases specialised, fungus applications to remove.
	Inspect for graffiti.	Use domestic cleaning fluids and/or specialised graffiti remover to remove.
Power casing (ABS)	Inspect for damage.	Remove any rough or sharp projections or if damage is severe, replace completely.
	Inspect for signs of fungal growth.	Use domestic cleaning products, or in severe cases specialised, fungus applications to remove.
	Inspect for graffiti.	Use domestic cleaning fluids and/or specialised graffiti remover to remove.

Roto Moulded Polyethylene Slides	Inspect for any damage to all surfaces paying particular attention to the slide bed and rails.	Areas that have minor damage can be smoothed with an abrasive paper. If the slide is severely damaged it may be possible to weld the plastic. Serious damage to a surface will require the equipment to be isolated from public use until such time as a repair or replacement is possible
Stainless Steel Slides	Inspect for any damage to all surfaces paying particular attention to the slide bed and rails.	Minor dents do not present significant hazards but holes or serious damage to a surface will require the slide to be isolated from public use until repair or replacement is possible
HDPE Panels	Inspect for any broken, missing or damaged parts, special attention should be given to areas or parts of the equipment that users can access them.	Where possible remove any rough or sharp edges to leave a smooth finish; if the component has suffered severe damage through vandalism it may need to be completely replaced.
	Inspect for signs of fungal growth	Use domestic cleaning products, or in severe cases specialised, fungus applications to remove
	Inspect for graffiti	Use domestic cleaning fluids and/or specialised graffiti remover to remove
Moving or rotating parts	These components have a sealed bearing and require little or no maintenance. Check that the component is operating correctly.	Replace completely if the component is not working.
Panels with a winding mechanism	The components should be firmly fixed to the panels.	Secure any loose components as these can cause accelerated wear.
Batteries	Battery cells are used in some products, check operation of product and replace with the same specification batteries, as required.	Dispose of used batteries in accordance with the manufacturer's instructions at a nominated recycling centre or return to the manufacturer for recycling.
Solar panels	Inspect for cleanliness and damage to the panel.	Regularly surfaces with damp cloth to maintain performance. If the panel is damaged it will not work as efficiently or at all. These should not be installed or located under trees or close to any object that can cast a shadow onto the solar panel and prevent it absorbing sunlight.
Sound box	Check operation.	Replace if not operating.
LED's	LED's used in memory and reaction games have a diagnostic setting to test operation.	Follow the specific instructions to test the LED's and replace as required.
Wiring & Connectors	Inspect wiring and connectors for corrosion	Replace as required

Waterproofing	Check that the components are secure and that seals are not damaged and allowing water ingress.	Care should be taken when disassembling any product with neoprene seals to ensure they are reinstated or replaced correctly to maintain waterproofing.
Spring bases	Check that the rust proofing applied to the base is not damaged prior to installation.	Touch up any damaged areas with a galvanised paint.
Springs & mounting plates	Inspect paintwork for any damage	Touch up damaged paint areas to prevent corrosion.
Polydek Panels & Parts	Inspect for any broken, missing or damaged parts, special attention should be given to areas or parts of the equipment that users can access them.	Where possible remove any rough or sharp edges to leave a smooth finish; if the component has suffered severe damage through vandalism it may need to be completely replaced.
	Inspect for signs of fungal growth	Use domestic cleaning products, or in severe cases specialised, fungus applications to remove
	Inspect for graffiti	Use domestic cleaning fluids and/or specialised graffiti remover to remove
Galvanised steel components	Inspect for any damage to the components	Touch up damaged areas as required
Mirrors (polycarbonate & stainless steel)	Inspect for surface cleanliness and damage	Care must be taken to avoid use of any abrasive materials, cleaning fluids or cloths as these will scratch the item
	Inspect for signs of fungal growth	Use domestic cleaning products, or in severe cases specialised, fungus applications to remove
	Inspect for graffiti	Use domestic cleaning fluids and/or specialised graffiti remover to remove
Moulded plastic components	Inspect items for any damage	Remove any sharp edges where possible or replace complete component
Games Tables	Inspect for cleanliness and damage	Care must be taken to avoid use of any abrasive materials, cleaning fluids or cloths as these will scratch the item
High pressure laminates	Inspect for any cleanliness damage	Chipped areas can create sharp edges which will need removing. Care must be taken to avoid use of any abrasive materials, cleaning fluids or cloths as these will scratch the item
Recycled profiles & posts	Inspect for any broken, missing or damaged parts, special attention should be given to areas or parts of the equipment that users can access them.	Where possible remove any rough or sharp edges to leave a smooth finish; if the component has suffered severe damage through vandalism it may need to be completely replaced.
	Inspect for signs of fungal growth	Use domestic cleaning products, or in severe cases specialised, fungus applications to remove
	Inspect for graffiti	Use domestic cleaning fluids and/or specialised graffiti remover to remove

Roto Moulded Polyethylene Slides	Inspect for any damage to all surfaces paying particular attention to the slide bed and rails.	Areas that have minor damage can be smoothed with an abrasive paper. If the slide is severely damaged it may be possible to weld the plastic. Serious damage to a surface will require the equipment to be isolated from public use until such time as a repair or replacement is possible
Stainless Steel Slides	Inspect for any damage to all surfaces paying particular attention to the slide bed and rails.	Minor dents do not present significant hazards but holes or serious damage to a surface will require the slide to be isolated from public use until repair or replacement is possible
HDPE Panels	Inspect for any broken, missing or damaged parts, special attention should be given to areas or parts of the equipment that users can access them.	Where possible remove any rough or sharp edges to leave a smooth finish; if the component has suffered severe damage through vandalism it may need to be completely replaced.
	Inspect for signs of fungal growth	Use domestic cleaning products, or in severe cases specialised, fungus applications to remove
	Inspect for graffiti	Use domestic cleaning fluids and/or specialised graffiti remover to remove
Moving or rotating parts	These components have a sealed bearing and require little or no maintenance. Check that the component is operating correctly.	Replace completely if the component is not working.
Panels with a winding mechanism	The components should be firmly fixed to the panels.	Secure any loose components as these can cause accelerated wear.
Batteries	Battery cells are used in some products, check operation of product and replace with the same specification batteries, as required.	Dispose of used batteries in accordance with the manufacturer's instructions at a nominated recycling centre or return to the manufacturer for recycling.
Solar panels	Inspect for cleanliness and damage to the panel.	Regularly surfaces with damp cloth to maintain performance. If the panel is damaged it will not work as efficiently or at all. These should not be installed or located under trees or close to any object that can cast a shadow onto the solar panel and prevent it absorbing sunlight.
Sound box	Check operation.	Replace if not operating.
LED's	LED's used in memory and reaction games have a diagnostic setting to test operation.	Follow the specific instructions to test the LED's and replace as required.
Wiring & Connectors	Inspect wiring and connectors for corrosion	Replace as required